

Instruction Manual

Medisound 922



KIND CUSTOMER

**THANK YOU FOR CHOOSING A GLOBUS PRODUCT, WE
ARE FULLY AVAILABLE FOR ANY ASSISTANCE OR ADVICE
REQUIRED**

The device has been produced by:

Home Care tecnologia CO., LTD
116, Lane 523, SEC. 3 JONGJHENG RD.,
RENDE DIST., TAIWAN CITY, TAIWAN.

hometech@hometech.com.tw

Imported and distributed by:

Domino s.r.l.
via Vittorio Veneto 52,
31013 Codognè (TV) ITALY
+39 0438 7933
www.globuscorporation.com
info@globuscorporation.com

SUMMARY

SPECIFIC TECHNIQUES	5
Labelling Description	5
INDICATOR AND CONTROLS	7
Warnings and informations for first use	7
PREPARATION FOR USE	8
CARE INSTRUCTIONS	9
CONTRAINDICATIONS FOR ULTRASOUNDS USE.....	11
MODE OF USE ULTRASOUNDS PROGRAMS.....	12
Use	13
Mode of application	13
INTENDED USE AND APPLICATION	15
ACTION MECHANISM OF THE ULTRASOUNDS	16
THERAPEUTIC INDICATIONS	18
Theraupetic effects.....	18
Ultrasounds application for beauty.....	20
Effects on aesthetic treatments	20
The adipose tissue	21
MODE OF USE SONOPHORESIS PROGRAMS	22
MODE OF USE MENS TYPE PROGRAMS.....	24
MODE OF USE “COMBO” PROGRAMS ULTRASOUNDS +MENS.....	26
ULTRASOUND TREATMENTS LIST	28
ULTRASOUND TREATMENT LIST	28
SONOPHORESIS TREATMENTS LIST	30
MENS TREATMENTS LIST	31
COMBO TREATMENTS LIST (Ultrasound + MENS).....	32
PROBLEM RESOLUTION	32
Frequently asked questions.....	34
WARRANTY TERMS.....	35
Products care	36
SOME AREAS TO TREAT	38

SPECIFIC TECHNIQUES

POWER SUPPLY: 24VDC

DIAMETER HEAD: 30mm

ULTRASOUNDS

POWER : 5 Watt, 9 voltage level

FREQUENCY ULTRASOUNDS: $1 \pm 5\%$ Mhz

Timer: From 1 to 30 min. Set up standard time 10 min.

Temperature: max 45°, set up standard 40°

Intermittent switch; 10 sec switched off

MENS

OUTPUT POWER: 0-1 VDC, 9 intensity level

TIMER: from 1 to 30 min. Set up standard time 10 min.

ADAPTER AC TYPE 48-240-0300 CE

Labelling Description

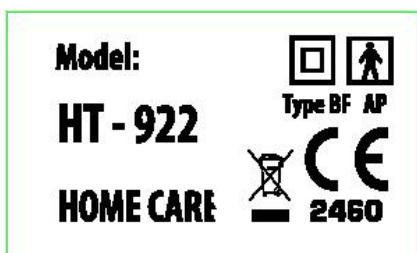

Symbol that indicates the double insulation

Symbol that indicates the applied parts type BF

This symbol on your device indicates that it is in

accordance with the requirements of the Directives about medical devices. The number of the notified unit is 2460.

E: The symbol WEEE (Waste of Electrical and Electronic Equipment). Symbol of Recycling.

WEEE symbol used for this product indicates that it cannot be treated as a domestic waste. The right disposal of this product will protect the environment. For more information about its recycling, please contact your local authority, your household waste disposal service or the shop where you purchased the product

The product complies with the electromagnetic compatibility, required of EN60601-1-2 as laid down in Directive 2007/47/EC (93/42/ECC-M5)

Do not use the instrument in proximity, less than 1 meter, of electrical appliances that emit small waves or microwaves, in so far as the emission could result instable in the work frequency (IEC601-2-10).

Conditions of conservation and transport

Temperature: 10-40° C

Air humidity: 20-75%

Atmospheric pressure: 700 hPa- 1060 hPa

Produced by: Home Care Technology Co., Ltd. -
No.116,Ln.523,Sec.3,Jhongjheng - Rd.,Rende Township, Tainan
Country - 71757, Taiwan, R.O.C.

Distributed by: Domino S.r.l. via Vittorio Veneto 52, 31013
Codognè (TV) Tel. 0438.7933 info@globuscorporation.com
- www.globuscorporation.com

INDICATOR AND CONTROLS

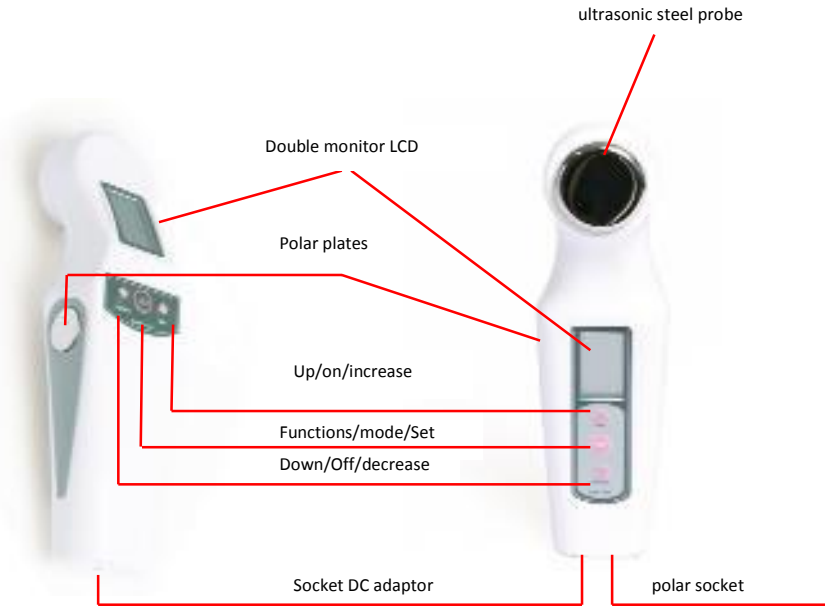

Warnings and informations for first use

Before using the stimulator read the following information:

- Carefully read this operating manual;
- Examine with care the apparatus and its parts to individuate eventual external damages;
- if the control unit is on but no indicators light up on the screen , switch off the device and switch on again. In case the problem still persists, contact the assistance centre without using the machine.

PREPARATION FOR USE



For the treatments in modality ULTRASOUND the user can use the device on himself. To do this, it is necessary to close the circuit placing two fingers on the polar plates and the head treatment on the zone to treat. To carry out an ultrasound treatment on another person, it is necessary to use also the adhesive electrodes placing them on the person to treat, in this way the circuit will be closed.

The device can be regulated in the same way both with the forward dashboard and with the posterior one.

The device works exclusively connected to the electrical grid through the adaptor supplied.

NOTE: When you turn on the machine, it is always set up on Ultrasound mode.

CARE INSTRUCTIONS

Maintenance and cleaning the device

- In case of damage of the covering apparatus, this has to be replaced and not used anymore.
- In case of real or presumed spoilt, do not make any repairs by yourself. Do not intervene on the machine, do not open it. Repairs can be carried out only by authorized centres.
- Do not give a shock to the product by clashing, overturning or shaking. It may cause trouble or accident in a long run although no immediate trouble occurs.
- Store the device at a place free from wet areas and water, avoid installing in places subject to humidity, high temperature, dust or places exposed to direct sunbeam or near to sources of high electromagnetic emission. The device must be used free and not wrapped or covered.
- Don't use thinner, gasoline, kerosene, cleaning powder or chemicals; for cleaning the machine and the cables, it is sufficient a soft lightly humid duster.
- After a long period of non-use, it is advisable to check the correct working of the machine and of the battery. (Contact authorized centres).
- The device is connected to the electricity by means of the apposite feeder. Before the connection check that electric system is complied with the requirements in force in your country.
- Don't take apart the apparatus; there are not parts repairable by the user.
- Don't detach the labels placed on the apparatus
- Don't wet the apparatus avoid installing it at open places subject to rain. Don't use the device after a possible water exposure.
- Don't carry the device holding it by the electric wire. Don't remove the plug from the socket by pulling it; keep the cables out of oils and objects with sharp edges. Don't use any extension cable.
- For the maintenance only use original spare parts.

- The improper use of products and not original spare parts will induce the loss of warranty.
- Use it for maximum 30 minutes, then keep it switched off for 30 minutes to dissolve the electronic components.
- Keep the device in places between 10°C-40°C

CONTRAINDICATIONS FOR ULTRASOUNDS USE

Do not use the ultrasounds in the following cases:

- Thrombophlebitis: ultrasounds could cause the breaking of embolus.
- Areas suffering from acute sepsis, the ultrasound could diffuse the infection.
- The radio therapy produces a contrary effect on tissues, for this reason ultrasounds have not to be used on areas subjected to radiations. Use ultrasounds at least 6 months after the last application.
- Don't use in case of tumours, ultrasounds can get worse your state and create metastasis.
- Don't use ultrasounds during the pregnancy they could cause fetus damages. The ultrasounds used during the pregnancy as diagnostic instrument, is different from that used for therapeutic aims.
- Patients with pacemaker should not be treated with ultrasound on thorax or column because the generator can have bad effects on the pacemaker functionality.
- Don't use ultrasounds on prosthesis and osteosynthesis material.
- Don't use in areas where synthesis of endo-tissu (for example plates entered after surgical operations).
- Don't use on children under 15.
- Don't use on organs such as ovaris, heart, head etc.
- Don't use in case of fever.

Warning

- the apparatus is suitable for non invasive use.
- the device must be used exclusively on undamaged skin.
- It is advisable not to use the apparatus together with other electronic equipment above all those used for support of vital functions.
- Read the manual carefully prior the use; keep this manual with care.

- In case of health problems seek your doctor before using the ultrasound.
- Check the device integrity before any use. This is an indispensable condition to carry out the treatments; don't use the unit if some defects or bad workings of switches should occur.
- The unit should be only used for the foreseen treatments, use it as stated in the operating instructions.
- The unit must be used only with the supplied diffusers and following therapeutic modality described in this manual.
- The user must keep the device out of reach of children or people with mental competence.
- Only producer accessories must be used with this device.
- Don't use the device near inflammables such as anaesthetics mixtures, oxygen and nitrogen potassium. Keep the unit, the cable and diffuser far from heat sources.
- Don't use the device in proximity, for example one meter, to domestic appliances that emit microwaves. The product therapy could be unstable in the emission of the operating frequency (IEC601-2-10).

In case of doubts or perplexity, it is necessary to contact your doctor

MODE OF USE ULTRASOUNDS PROGRAMS



Use

- Insert the adaptor supplied with the unity.
- Put some gel on the ultrasonic probe.
- Push the button "Up" to turn on the device. The default time is 10 minutes and the maximum temperature on the probe is 40°.
- Both the temperature and the Timer are displayed every 3 sec.
- Push the button "Up" or "Down" to select directly the desired power.
- choose the intensity level between the 9 available ones.
- to switch off the device lead the intensity to the 0 level and push "Down".
- to change the default setting push the button "Set" one time, the "Timer" will flash lights on the display.
- push the button "Up" and "Down" to set up the desired time (from 0 to 30 min). When you have finished the setting up push "Set" once.
- the unit places itself on stand-by.
- the intensity level of the device will automatically reduce, when the temperature will be set up at maximum level.
 - push the button "Up" or "Down" to select the power.
- At the end of the program the device will switch off automatically

ATTENTION: during the self-treatment the fingers have to be placed on the polar plates sides, carrying out circular motions on skin with the metal side of the treatment head.

Mode of application

The air lessens the ultrasounds, so it is necessary to always interject a certain quantity of gel for ultrasounds, between the

head treatment and the surface of skin to treat. The head treatment have to be applied to the zone to treat and slide slowly, without too much pressure, collect at times the gel or the cream used.

Before proceeding with the application, clean accurately the skin and be sure that there are not any traces of cleanser or other products.

When the program starts it is recommended to make first penetrate the anti-cellulite cream, and later apply the Globus gel.

Start the program and lean the device head on the naked part to treat.

To avoid the overheating of the treated part, move the treatment head in a slow and circular way, back-and-forth or as drawing an eight number.

According to the program you will feel a light vibration or a light warmth.

INTENDED USE AND APPLICATION

Intended Use

Carefully read the user manual in order to avoid incorrect installation, use and maintenance operations which may damage the device, the operator or the user. Ultrasound devices are designed to be used for the following range of operations:

- home environment
- general pain treatment;
- cosmetics and sports purposes;
- general rehabilitation
- outpatient setting
- physiotherapy field

The use of this device is allowed to the patient himself (conveniently informed about the methodologies used by the machine) and to the medical and paramedical personnel.

What are Ultrasound

Ultrasound is defined as an acoustic vibration with frequencies above the limit of audible sounds (superior of 20.000 Hz).

Ultrasonics with therapeutic purpose were introduced and studied in a systematic way after the Second World War. They were immediately diffused in Italy and a lot of Italian academics contributed significantly to the experimental and clinical research in this field.

Ultrasound spread as compression- decompression waves, with a back-and-forth motion of the transmission means parcels, parallel to the direction of the propagation wave.

Ultrasonics are artificially produced through the piezoelectric effect using a quartz or a ceramic disc.

ACTION MECHANISM OF THE ULTRASOUNDS

Mechanical effects:

the mechanical action is due to the movement of the tissues particles crossed by the ultrasonic wave.

Although the movement endured from single particles is small, the pressure variations that it produces are so considerable to generate important mechanical effects on tissues.

The induced mechanical modifications determine:

- a) acceleration of the processes of diffusion through cellular membranes.
- b) complex molecule division (proteins, polysaccharides., etc).
- c) tissue Micromassage.

Thermic effects;

the passage of ultrasounds through "the soft" tissues creates an elevation of the temperature for:

- absorption due to the viscosity,
- absorption due to the thermic conductivity and chemical absorption.

The ultrasounds produce heat through the vibrations, the collision and the friction of the cellular and intercellular structures that compose the tissues, crossed by the sonorous waves. The thermal elevation generates, as secondary effects, an increasing of the cellular metabolism and vasodilatation.

Chemical effects:

the chemical action with modification of the local ph, the permeability of cellular membranes and with molecular changes is caused by the remarkable forces of acceleration to which particles of the tissues are subjected at the passage of the ultrasonic wave.

Cavitation effects: It is a phenomenon that appears in a liquid under a strong pressure. When the absolute pressure get inferior to the liquid vapour pressure, a vapour in the form of little bubbles is developed. Even if the cavitation can develop in the tissues, it needs a superior intensity than in the liquids, and we must consider that around 60% of the human's body is made of water. It is intuitive that the application of the ultrasounds on biological material imbibed with water causes a remarkable cavitation effect, that is the production of micro-bubbles for effect of the cavitation in the water.

The cavitation phenomenon and its efficacy are connected to the emission power of the wave and their frequency. Lower is the emission frequency, greater is the cavitation effect produced in the tissues, then greater its efficacy in the lipolysis. Adipose cells in particular are more easily exposed to the cavitation effect than the more resistant structures.

The dynamics of the process is very alike to the boiling one. The main difference between the cavitation and the boiling is the vapour pressure inside the liquid. In the cavitation is created a strong depression that causes the separation of the air contained in the liquid, forming some gas cavities that imploding emit a quantity of energy that separates the fat macromolecules in the mono-and triglycerides adiposities, making the lipase action, and the following use by the body, more efficient.

The effects are a progressive modelling of the body's outline, the reduction of the fat, the improvement of the "orange peel" skin aspect with an attenuation of the cellulite nodes, the reactivation of the district peripheral circulation and the drainage of the excess fluids. Also the skin tone and elasticity have benefits.

THERAPEUTIC INDICATIONS

The ultrasound therapy treats efficiently muscular, tendon and ligament pathologies. In addition it is used for scars, skin pathologies, inflammations, rigidity and joint degeneration. All the locomotory apparatus pathologies in which an analgesic effect is desired. In the sciatica and general neuritis (reduced intensity and irradiation along the cutaneous projection of the nervous trunk to be treated). In the Scapular humeral periarthritis the ultrasound therapy is able to disintegrate the calcifications and to favour reabsorption of the calcium salts sediment. It is useful to improve the efficacy of the kinesiotherapy sessions. It can be used as analgesic in the arthritic and periarthritic symptoms, to facilitate the hematoma reabsorption, to stimulate the tissues healing, to facilitate the resolution of the muscular spasm, to increase the elasticity of the connective tissue, in the contractures, to favour the wound healing and to reduce or delay weak calcifications.

Therapeutic effects

The ultrasound therapeutic effects are in part caused by the temperature increase. They are the analgesia, muscle relaxation and the fibrolytic and trophic effect.

1) Analgesia

The analgesic effect is due to the heat action and probably also to a direct action of the ultrasound on the sensory nerve endings.

2) Relaxation of the contracted muscles

The relaxation of the contracted muscles is due to the thermic effect and to the tissue micromassage action of the ultrasounds.

3) Fibrolytic action

The oscillations of tissue particles produced by ultrasound, determine the disintegration of the collagen fibers of the fibrous tissues.

4) Trophic effect

The vasodilatation, caused by the thermal elevation, facilitates the catabolic removal and supplies the tissues of nutritive substances and oxygen; in this way ultrasound improves the tissue trophism, facilitate the repair of the damaged tissues and accelerate the resolution of the inflammatory processes.

The ultrasounds are used for the treatment of tendon, capsular, periosteal structures pathologies. In particular are advisable for treatments of:

1) Tendinitis

This technique is particular efficient in tendinitis, capsulitis, bursitis, coccyx pain.

2) Muscular contractions

Involuntary contraction of one or more scheletric muscles.

3) Arthrosis/arthritis

Inflammatory process of one or more articulations that can appear in a chronic or acute form, arthritis is caracherised by pain, reddening and swelling and it is normally caused by an inflammatory process or by a traumatic wound.

4) Neuralgia

Process of peripheral nerve inflammation causing pain and swelling.

5) Lombago

Pain of the lumbar and sacral region causing strong tension and pain.

6) Myalgia

Muscle pain that involves the muscle bundles and soft tissues, caused by a muscular tension or wound.

Ultrasounds application for beauty

The ultrasound functions applied to the beauty and to the fitness are a lot, thanks to the non-invasive and painless action and to the consequent increase of the metabolism and the elimination of waste products.

They facilitate the absorption of active substances like essential oils, fat-soluble vitamins, cosmetic products, emulsions, water-soluble agents, through the epidermis.

They stretch the tissues: the ultrasound thanks to the thermic and mechanical effect, interact with the tissue favouring the biochemical and metabolic processes. Great for surface wrinkles distension.

They activate the regenerating anti-inflammatory processes in case of acne and spots: the ultrasounds activate the fibroblasts which are very important for the tissue regeneration. The collagen that is produced after the treatment increases the tissue elasticity reducing the formation of scars.

Effects on aesthetic treatments:

Cellulite: Program created to decrease the hypertrophy of the fat cells, which is caused by the alteration of the

lymphatic system balance. It improves the velocity of the blood flow and of the elimination of the water retention through cavitation. The cavitation improves the lymphatic stasis releasing triglyceride from the intradipocitaria vacuoles. The triglycerides collected from the lymphatic and venous system reach the systemic circulation to be used or delated by the organs.

Adipous tissue: program thought to delate the fat accumulation in the areas of legs, thighs, gluteus, arms, abdominal law belly, back and breast.

Drainage: specific program to delate the fluids accumulation and their slump.

Massage: program designed to delate the muscular-nervous tensions. Specific to relaxe the tens musculature.

Scars: program designed for the skin trophic status and to distance the skin physiological ageing.

Stretch marks: program created to eliminate the dermo-epidermal atrophies, due to the break of the derma elastic fibers.

The adipose tissue

The adipose tissue represents the main sediment of triglycerides.

It is compounded by copious adipose cells, essential for the triglycerides synthesis. The fluids are in part of exogenously sourced and in part of endogenous origin. The thickness and the distribution of the panniculus adiposus depends on different factors. The thickness of the adipose tissue is different in the two genders. The fat mass is concentrated in

the hips, gluteus and thighs for women . For men the distribution is especially in the abdomen.

The adiposities entity depends on the nutritional state and on the life style. Many persons think that the fat masses accumulated in specific areas are impossible to remove. The triglycerides of the adipose tissue are in reality continuously mobilized, renewing every 10-15 days.

The adipose tissue functions are:

- energy reserve
- heat insulation

White adipose tissue and brown adipose tissue

The white adipose tissue represent almost the totality of the fat reserve. The other kind of tissue, known as brown, is present in little quantities in newborn. With the growth, a great part of it becomes white adipose tissue;

for this reason there are in adults only a very little quantity of brown adipose tissue, distributed only in form of cells scattered between numerous adipocytes.

The functionality of the white adipose tissue is the triglycerides synthesis and the storing as energy reserve, the mechanical shock absorber, the thermic insulation and producer of hormones and biologically active substances.

MODE OF USE SONOPHORESIS PROGRAMS

ATTENTION: to carry out the sonophoresis treatment it is necessary to use the small cable with two adhesive electrodes, together with the metal part of the device head.

These applications are for medical aim, therefore they

have to be carried out only with medical personnel approval.

The sonophoresis is a method that uses ultrasounds to increase the skin permeability, in order to favour the absorption of active ingredients and sera.

To carry out this treatment you have to place a sufficient dose of cream on the interested part, mix it with the gel and start the treatment.

To choose the medicine to use, consult your doctor.

The combination of the two methods (ultrasound and medicine) amplify the result of the individual methods.

Precautions

If the intensity is too high and you carry out the process in a not meticulous way, this effect can causes irritation and burns on skin. The skin must not be injured (do not shave your skin before the treatment to avoid micro cuts caused by the razor).

Persons with metallic implants are forbidden to use SONOPHORESES programs. The patient must not be in contact with metallic elements (Es. Table or chairs).

Use

- Insert the power adapter supplied with the unit.
- Connect the supplied cable to the polar socket (see picture pag.4) and insert the electrodes in the specific plug. Apply the electrodes on the skin.
- Put some gel on the ultrasonic probe.
- Push the button "Up" to turn on the unit.
Keep pushing the "Set" button for 2 sec. to set up the ionophoresis function.
- The timer setting of 10 minutes and the "P1" program will display every 3 sec.

- Push "Up" or "Down" to set up the desired power.
- Choose the intensity level between the 9 available ones.
- To switch off the device lead the intensity level to the 0 level and push "Down"
- To change the default settings push the "Set" button one time, the "Timer" will flashes on the display.
- Push the "Up" or "Down" button to set up the desired time (from 0 to 30 min.)

When the time setting is complete, push "Set" one time and the "ES" abbreviation will flashes on the display.

- Push the "Up" or "Down" button to select the programs "P1 or P2 or P3".

Confirm the program with the "Set" button.

- Push the "Up" or "Down" button to select the power.
- At the end of the program the device will automatically switch off.
- To return to the Ultrasounds mode, keep pushing the "Set" button for 2 seconds.

MODE OF USE MENS TYPE PROGRAMS

ATTENTION: to carry out the MENS treatment it is necessary to use the small cable with two adhesive electrodes, together with the metal part of the treatment head.

These applications are for medical aim, therefore they have to be carried out only with medical personnel approval.

The microcurrents use currents which voltage is included between 10 and 500 μA (microampere, that is a millionth of one ampere). Numerous researches proved that the

currents in the microampere range increase the ATP synthesis.

The MENS then, constitute an interesting instrumental therapy that can be applied for numerous pathologies, and above all it can be applied to other kind of instrumental therapies (for example the ultrasounds) and can yield excellent medical results that would be difficult without Mens to achieve.

NOTE: Microcurrents use microampere (not milliampere like the conventional electrostimulation therapies), imperceptible to humans. It is normal then do not sense any perceptions.

Use

- Insert the power adapter supplied with the unit.
- Connect the cable supplied to the polar socket (see picture pag.4) and insert the electrodes in the specific plug. Apply the electrodes on the dermis.
- Put some gel on the ultrasonic probe.
- Push the "Up" button to turn on the unit.
- Keep pushing the "Set" button for 2 sec.
- Push again twice the "Set" button.
- The notice "Es" flashes.
- With the "Up" button select one of the Tens programs (P4 or P5 or P6)
- Push "Set" to confirm.
- Push "Up" or "Down" to set up the desired power.
- Choose the intensity level between the 9 available ones.
- To switch off the device, lead the intensity level to the 0 level and push "Down".
- To change the default settings push the "Set" button once, the "Timer" will flash on the display.
- Push the "Up" or "Down" button to set up the desired time (from 0 to 30 min.)

When the time setting is complete, push "Set" once and the notice "ES" will flash on the display.

- Push the "Up" and "Down" button to select the programs "P4-P5-P6". Confirm the program with the "Set" button.
- Push the "Up" or "Down" button to select the power.
- At the end of the program the device will automatically switch off.
- To return to the Ultrasound mode, keep pushing the "Set" button for 2 seconds.

MODE OF USE "COMBO" PROGRAMS ULTRASOUNDS +MENS

ATTENTION: to carry out the "Combo" treatment it is necessary to use the small cable with two adhesive electrodes, together with the metal part of the treatment head.

These applications are for medical aim, therefore they have to be carried out only with medical personnel approval.

The COMBO technique permits to exploit the actions of two treatments (ultrasound + Mens) in an unique therapy session.

The COMBO technique can be used for the self-treatment and also to treat another person.

Precautions

If the intensity is too high and you carry out the process in a not meticulous way, this effect can causes irritation and burns on skin. The skin must not be injured (do not shave your skin before the treatment to avoid micro cuts caused by the razor).

Persons with metallic implants are forbidden to use COMBO programs. The patient must not be in contact with metallic

elements (Es. Table or chairs).

Use

- Insert the power adapter supplied with the unit.
- Connect the cable supplied to the polar socket (see picture pag.4) and insert the electrodes in the specific plug. Apply the electrodes on the dermis.
- Put some gel on the ultrasonic probe.
- Push the "Up" button to turn on the unit.
- Keep pushing the "Set" button for 2 sec.
- Push again twice the "Set" button.
- The notice "Es" flashes.
- With the "Up" button select one of the Combo programs (P7 or P8 or P9)
- Push "Set" to confirm.
- Push "Up" or "Down" to set up the desired power.
- Choose the intensity level between the 9 available ones.
- To switch off the device, lead the intensity level to the 0 level and push "Down".
- To change the default settings push the "Set" button once, the "Timer" will flash on the display.
- Push the "Up" or "Down" button to set up the desired time (from 0 to 30 min.)
- When the time setting is complete, push "Set" once and the notice "ES" will flash on the display.
- Push the "Up" and "Down" button to select the programs "P4-P5-P6". Confirm the program with the "Set" button.
- Push the "Up" or "Down" button to select the power.
- at the end of the program the device will automatically switch off.
- to return to the Ultrasound mode, keep pushing the "Set" button for 2 seconds

ULTRASOUND TREATMENTS LIST

Pain/ Rehab	Duration	Intensity and ref.picture
Sciatica	18 min	Level 5 – pic.13
Lombalگو	18 min	Level 5 – pic. 15
Arthritis/arthrosis	15 min	Level 7 – painful limb
Neuralgia	20 min	Level 6 – painful zone
Hematoma	20 min	Level 5 – painful zone
Scars	18 min	Level 4 - interested zone
Carpal tunnel	20 min	Level 6 - pic. 7
Tennis arm	20 min	Level 7-pic.3
Periarthritis	20 min	Level 7 – pic.11
Sprain	20 min	Level 8 – pic.14
Heel pain	15 min	Level 6 – pic-8
Myalgia	30 min	Level 7 – interes. muscle
Tendinitis	15 min	Level 5 – pic.4
Muscle/artic. pain	30 min	level 8 - interest. Limb
Upper limbs pain	20 min	level 7 – pic. 6-7-11-12
Lower limbs pain	30 min	Level 9 – 2 -5 -10 -13- 15

ULTRASOUND TREATMENT LIST

Skin	Duration	Intensity and ref. picture
Wrinkles	12 min.	level 4 – pic. 16
Stretch marks	30 min.	level 8 – interested zone
Absorption Active principles	25 min.	level 9 –interested zone

Skin	Duration	Intensity and ref. picture
Cellulite	30 min	level 9 – interested zone
Fat	30 min.	level 9 – interested zone
Massage	30 min.	level 8- interested zone
Drainage	30 min.	level 8- interested zone

SONOPHORESIS TREATMENTS LIST

Program	Intensity	Duration	Aim
P1	Low	10 minutes	Ideal for the carriage of the active principle in small articulations
P2	Medium	10 minutes	Ideal for the carriage of the active principle in big/medium articulations
P3	High	10 minutes	Ideal for the carriage of the active principle with immediate action

MENS TREATMENTS LIST

Program	Program Mens	Voltage	Pos. Electrode
General pain	P4+P6	level from 7 to 9	Painful zone
Arthrosis/Arthritis	P4	level from 7 to 9	painful zone
Muscle pain	P4+P6	level from 7 to 9	painful zone
Neuralgia	P4+P5	Level from 7 to 9	painful zone
Knee pain	P4+P6	Level from 7 to 9	Pic.18
Trapezius pain	P4+P6	level from 7 to 9	Pic.19
Thigh pain	P4+P6	level from 7 to 9	Pic.20
Shoulder pain	P4+P6	level from 7 to 9	Pic.21
Elbow pain	P4+P6	level from 7 to 9	Pic.22
Hip pain	P4+P6	level from 7 to 9	Pic.23
Sciatica	P5	level from 7 to 9	Pic.24
Lumbago	P5	level from 7 to 9	Pic.25
Cervical	Pg	Level from 7 to 9	Pic.26

COMBO TREATMENTS LIST (Ultrasound + MENS)

Pathology electr.	Programs combination	Intensity	Posiction
Muscle pain	P7	Level 9	Painful muscle
Neuralgia	P7+P8	Level 6	Painful zone
Knee pain	P7+P9	Level 8	Pic.18
Trapezius pain	P7+P9	Level 8	Pic.19
Thigh pain	P7+P9	Level 8	Pic.20
Shoulder pain	P7+P9	Level 8	Pic.21
Elbow pain	P7+P9	Level 8	Pic.22
Hip pain	P7+P9	Level 8	Pic.23
Sciatica	P8	Level 7	Pic.24
Lombalgo	P8	Level 7	Pic.25
Cervical	P7	Level 6	Pic.26
Rheumatic pain	P7+P8	Level 9	Painful zone
Osteoarthritis pain knee	P9	Level 9	Pic.18
Phantom limb	P8	Level 9	Painful zone

PROBLEM RESOLUTION

PROBLEM	POSSIBLE CAUSES	PROBLEM RESOLUTION
No vibrations	<ul style="list-style-type: none"> - Intensity level. 0 (Unit in stan-by) - not working timer - Temperature higher than the selected one - not working circuit - broken unit 	<ul style="list-style-type: none"> - increase the intensity level - reset the intensity level - decrease the intensity level or switch off the unity - control the power
Intermitting vibration	<ul style="list-style-type: none"> - too much high temperature - circuitry anomaly - mixed wave 	<ul style="list-style-type: none"> - decrease the intensity level - interject the gel or some cream on the machine's head or on the skin - reset the modality ultrasound
The device does not turn on	<ul style="list-style-type: none"> - the unity is humid in the inside - the power supply loses contact - broken adaptor - broken unity 	<ul style="list-style-type: none"> - dry the residual humidity of the device, do not use it for 24 hours - insert the power supply completely - change it with a new adaptor - contact the dealer

Frequently asked questions

Can ultrasound therapy cause any harm?

Ultrasounds applications do not cause any harm expect when used in contraindicated cases (see chapter "Contraindications").

If during the program doesn't perceive anything or the light vibration is not always felt, What does it means?

The treated zone is less sensitive but this does not mean that the ultrasound is not effective.

How do I have to use the Head of treatment?

The head of treatment must always slide otherwise the treated area could overheat and cause an unpleasant feeling.

It is therefore necessary to follow the manual indications to use the ultrasounds, on the whole zone stimulating the blood circulation of the treated areas.

Is it always necessary to use the Globus Gel on skin and treatment head?

Yes and the quantity must be sufficient for all the involved area, otherwise the ultrasounds are not transmitted and the head of treatment could overheat losing its effect and above all it could cause unpleasant feelings

How can I clean the treatment head ?

To clean the treatment head after each application is extremely important. The Gel or cream residuals, drying, can cause the production of bacterium or moulds and compromise the correct working of the ultrasonic transducer incorporated with the treatment head. To clean it follow the instructions indicated in paragraph "Care instructions"

Is it possible to use ultrasounds during the menstrual cycle?

Interferences such as early or late periods or heavier or lighter flows are extremely subjective and variable. In any case it is

recommended to avoid treatments during the cycle and immediately before or after it.

Can I have applications during pregnancy?

NO, these applications are absolutely contraindicated.

It is possible to use ultrasounds on children?

NO, it is absolutely forbidden.

I have a pace-maker, can I still use the device?

NO, the use of ultrasound therapy devices is contraindicated for people with pace-makers. Seek your doctor's advice.

How long does it take for the first results to become apparent in the cosmetic field?

The results achieved in the cosmetic field are obviously subjective. Better and quicker results can be achieved if combined with a good physical activity and a healthy life style.

If the treatment cable should have fissures or the cable should be damaged, can I use them?

Absolutely not!

How many treatments Do I have to carry out?

It is recommended on the same part of the body 3-4 weekly treatments.

WARRANTY TERMS

The device is guaranteed to the first user for a period of twenty-four (24) months from date of purchase against defects in materials or workmanship, provided that properly used and maintained under normal conditions of efficiency.

The warranty, if the user uses the device with professional purposes, shall be twelve (12) months from date of purchase against defects in materials or workmanship, if properly used and maintained under normal conditions of efficiency.

Warranty coverage is limited in the following cases:

- Six (6) months for supplied accessories such as batteries, chargers, power supplies, cables, etc.;

- Ninety (90) days for the media containing software such as, for example, CD-ROMs, memory cards, etc.
- No warranty for accessories and materials to be considered "consumables" such as, for example, electrodes, etc..

The guarantee is valid and enforceable in the country where the product was purchased. In the event that the product is purchased in any country of the European Community, the warranty is still valid in all its countries.

To obtain warranty service, you must comply with the following warranty clause:

1. The products will be delivered for repair at the expense of the Client in original packaging.
2. The product warranty will be subject to the exhibition of a receipt (tax invoice, receipt or bill of sale), confirming the date of purchase.
3. The repair will not affect the original expiry date of the guarantee and will not lead to the renewal or extension thereof.
4. In case, when the repair work, we find no defect in the product itself, will still be charged for the costs of check technique.
5. The warranty declines if the failure was due to knocks, falls, misuse or abuse of the product, use of an adapter or charger different from the original, accidental events, product alteration, replacement and posting of security seals and / or tampering product. The same also does not cover damages caused during the transport with not proper packaging.
6. The warranty is not responsible for the inability to use the product, other incidental or consequential costs or other expenses met by the buyer.

Products care

Before returning the machine for repair, we recommend to read carefully the instructions in the manual and visit Globus website in Club My Globus area under "what to do in case of problems."

In case you need to return your product for assistance, contact your dealer or contact Globus Service in www.globuscorporation.com, always accessing Club My Globus Area. Globus product support may be required to the dealer where you purchased the product or visiting Globus website in the Club my Globus.

Images, features and data presented in this manual are not binding and are subjects to changes by the manufacturer without obligation of prior notice.

AREAS TO TREAT



Fig.1



Fig.2



Fig.3



Fig.4



Fig.5



Fig.6



Fig.7



Fig.8



Fig.9



Fig.10



Fig.11



Fig.12



Fig.13



Fig.14



Fig.15



Fig.16



Fig.17

SOME AREAS TO TREAT SONOFORESI-MENS-COMBO



Fig.18



Fig.19



Fig.20



Fig.21



Fig.22



Fig.23



Fig.24



Fig.25



Fig.26

